

- $\pm 1\text{ }^{\circ}\text{C}$
- HUMICAP<sup>®</sup>
- (10... 28VDC)
- DM70
- HM70
- LED

HUMICAP<sup>®</sup>

DMT132  
OEM

HUMICAP<sup>®</sup>

G1/2" ISO  
DMT132

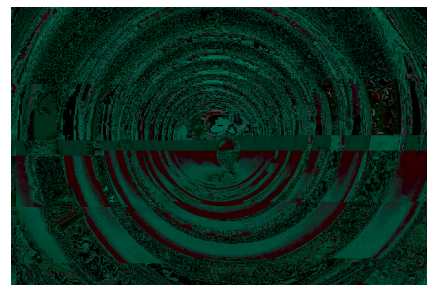

DMT132

-3... 20 $^{\circ}\text{C}$

$T_d$

$\pm 1\text{ }^{\circ}\text{C}$

10VDC

DMT132

DM70 HM70  
DMT132

HMK15

		-30... +50 °C T <sub>d</sub>	
+20 °C		-3... 20 °C T <sub>d</sub> ± 1 °C <sup>1)</sup>	
		-15... -3 °C T <sub>d</sub> ± 2 °C <sup>1)</sup>	
	20 °C	1	
-14	+3 °C T <sub>d</sub>	17 s (63%)	
		40 s (90%)	
+3	-14 °C T <sub>d</sub>	33 s (63%)	
		85 s (90%)	

T<sub>d/r</sub> atm

1) 0 °C

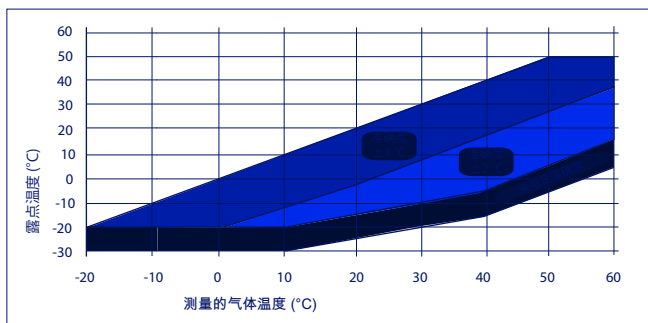

	230602
HMK15	230914
DMT132 HMP60	
NPT	210662SP
	DMT242SC DMT242SC2 DSC74 DSC74B DSC74C DMCOIL
	DM240FA
	HMP50Z032 HMP50Z300SP HMP50Z500SP HMP50Z1000SP
	226476
USB	219690
	DM70/HM70 219980
LED	230388
ISO 1/2"	218773
NPT 1/2"	222507
3 U	221525SP

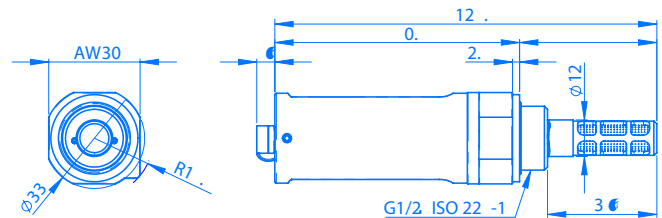

mm



	-30... +50 °C
	0... 20 bar
	0... 100% RH
EMC	EN61326-1

	4... 20 mA 2
	0.002 mA
+20 °C	± 0.05 %
	± 0.005 % / °C
	4 M8 (IEC 60947-5-2)
LED /	RS-485

	HUMICAP® 180R
	2
	G1/2" ISO
	10... 28 VDC
	< 20 VDC 100
	20... 28 VDC
	500
	65 g
	PPS + 40% GF
IP	IP65 (NEMA 4)
	-40... +80 °C
	3 s